

# Touch Screen

|          |             |
|----------|-------------|
| Catalog# | Prepared by |
| Project  | Date        |
| Comments | Type        |

## Overview

Fifth Light's Touch Screen provides graphical control of the lighting system at your fingertips. A large visual display makes it easy to adjust light levels and apply preset scenes. Control multiple types of lighting devices from a single easy to use interface.

## Features

- Adjust light levels by pressing the up and down arrows or the On and Off buttons
- Apply lighting scenes by selecting appropriate preset button
- Virtual groups defined through software avoid hard wired high voltage connections
- Ethernet interface shares data on existing Local Area Networks



## Specifications

| Catalog #         | (See ordering chart)  |
|-------------------|---|
| Performance       | <b>Input Voltage:</b> 24 VDC supplied by Lighting Control Panel                           |
|                   | <b>Power Consumption:</b> 12.1 Watts  |
|                   | <b>Operating Environment:</b> 32°F to 104°F (0°C to 40°C)<br>For indoor use only          |
|                   | <b>Dimensions:</b> 5.75"H x 7.28"W x 2.45"D<br>(136mm x 185mm x 62.3mm)                   |
| Wiring & Mounting | <b>Power:</b> Wire terminal connection, use 14 to 18 AWG solid/stranded LV pair           |
|                   | <b>Network:</b> 2 - RJ45 Ethernet connectors 10/100 Mbps                                  |
|                   | <b>Mounting:</b> Mounting frame included with product. See back/next page for dimensions. |

## Dimensions

(Inches/mm)

- Touch Screen

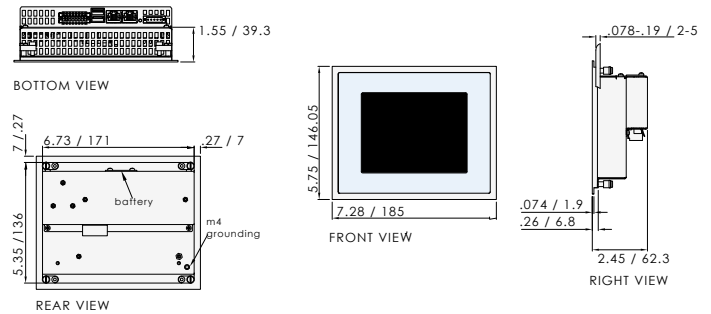
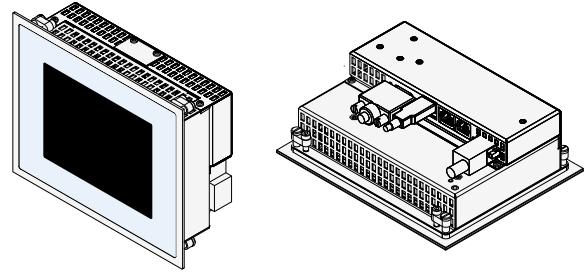

- Mounting Frame

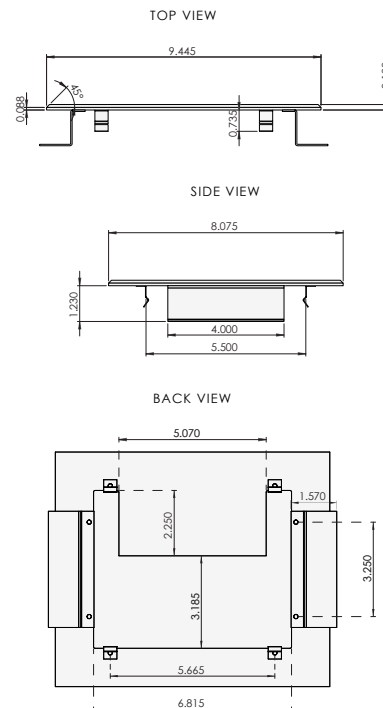
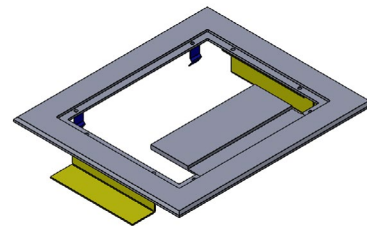

Sample System Topology

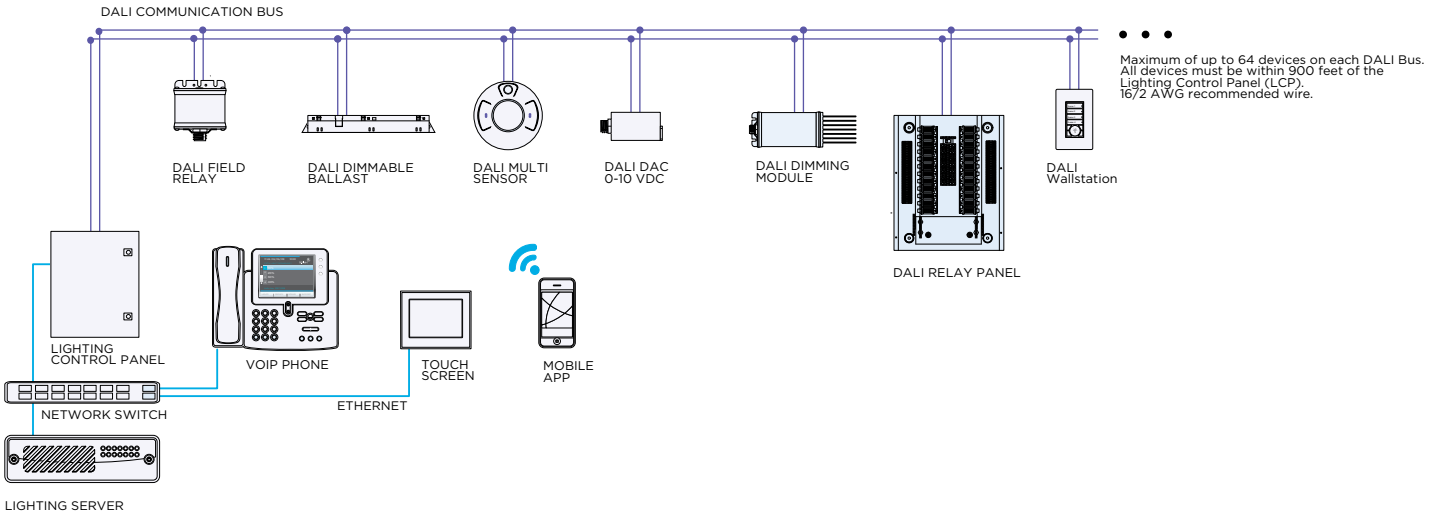

Ordering

| Catalog # | Description                                  |
|-----------|--|
| FLT-TS    | 5.7" Touch Screen, Includes Mounting Bracket |
| FLT-TS-MB | 5.7" Touch Screen Mounting Bracket           |