

Project		Catalog #		Type	
Prepared by		Notes		Date	



## Fifth Light

### FLT-MTS6-DALI / FLT-MTS12-DALI

#### Multi-Sensor

#### Typical Applications

Office • Education • Healthcare • Hospitality • Retail

#### Interactive Menu

- Ordering Information [page 2](#)
- Additional Resources [page 3](#)
- Product Warranty

#### Product Certification



#### Product Features



#### Top Product Features

- Daylight sensing and occupancy detection in a single device
- All device settings programmable through software
- Ultra low profile and small diameter
- Eliminates the need for external power packs
- Shares sensor data with third-party automation systems

#### Dimensional Details

Top View

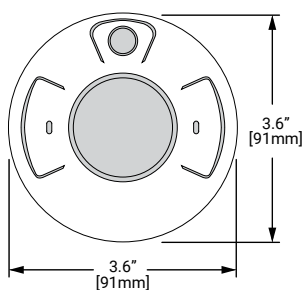

Side View

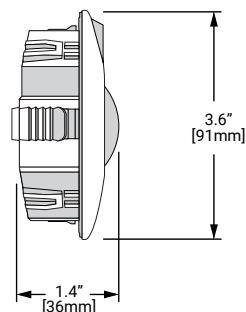

Junction Box Mounting Plate

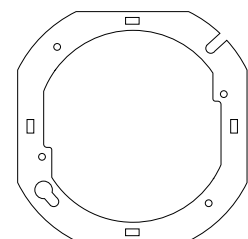
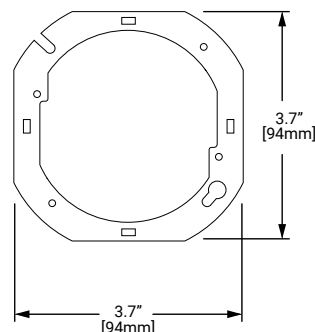

• The Multi-Sensor is designed to be installed into ceiling tile or onto a junction box.

[additional product diagrams](#)

## Order Information

## Catalog Number

Catalog Number	Description
FLT-MTS6-DALI	600 sq. ft. Multi-Sensor for daylighting and occupancy
FLT-MTS12-DALI	1200 sq. ft. Multi-Sensor for daylighting and occupancy

## Product Specifications

## Key Features

- Daylight sensing and occupancy detection technologies combined into a single device
- All device settings (timers, sensitivity and groups) programmable through software, no physical adjustments needed
- Ultra low profile and small diameter provides an aesthetically pleasing design
- Powered by the Fifth Light two-wire communication bus

## Mechanical

**Coverage:** 600 or 1200 sq. ft. at 8' ceiling height

**Occupancy Detection Technology:** Passive Infrared (PIR)

**Lens Type:** Multi-level Fresnel 360°

**Daylight Sensing Range:** 0 to 400 lux

**Daylight Sensing Coverage:** Light input within 60° cone

**Mounting:** 4" octagon junction box or 3" hole in ceiling tile

**Operating Environment:** 32°F to 104°F (0°C to 40°C) - For indoor use only

**Dimensions:** 3.6"H x 3.6"W x 1.4"D (91mm x 91mm x 36mm)

## Electrical

**Status Indicator:** 2 LEDs: Blue (occupancy), Red (power)

**Input Voltage:** 9.5 - 22.5 VDC supplied by communication bus

**Wiring:** 18 AWG stranded PTFE plenum rated

## Control Specification:

- **Communication Interface:** Two wire communication bus
- **Current Draw:** 3.75mA

**Standards:** Manufactured in an ISO 9001 certified factory

## Standards/Ratings

- Class 2 Input
- FCC Part 15/ECES-003
- Manufactured in an ISO 9001 certified factory
- Meets ASHRAE Standard 90.1 requirements
- Meets IECC 2015 requirements
- Meets CEC Title 24 requirements

## Product Safety:

- IEC 60950-1
- UL 60950-1
- EN 60950-1
- CAN/CSA-C22.2 No. 60950-1

## Environmental Regulations:

- RoHS Directive 2011/65/EU
- WEEE Directive 2012/19/EU

## Warranty

Five year warranty standard

## Coverage

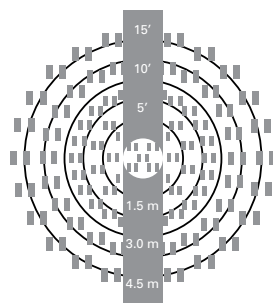

**Coverage Area**  
600 sq. ft.

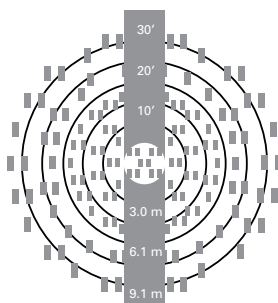

**Coverage Area**  
1,200 sq. ft.

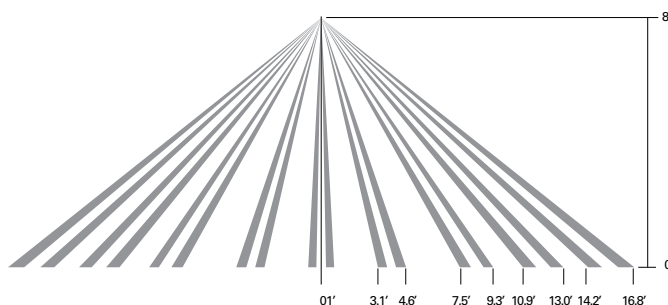

## Overview

Cooper Lighting Solutions' Multi-Sensor combines daylight sensing and occupancy detection into a single device. The Multi-Sensor communicates over the Fifth Light two-wire communication bus and allows for all device settings and groups to be adjusted remotely.

## System Architecture

This diagram illustrates the main components of the Fifth Light system. The DALI wallstations, DALI multi-sensors, DALI field relay, DALI dimming module, DALI DAC and DALI dimmable drivers/ballasts communicate with the Lighting Control Panel over the DALI bus while the touchscreen communicates with the Central Manager via ethernet.

Complete Fifth Light system

