

DESCRIPTION

The Prevail™ LED pole and fixture combination makes selection and installation of poles and fixtures simple. Included is the die-cast Prevail area, site and roadway luminaire with standard mounting arm, square straight steel pole, anchor bolts, base cover, template and hardware. Stock configurations are available in single and dual fixture combinations. The Prevail luminaire delivers a new level of versatility and value in patent pending, architectural design that delivers energy savings greater than 85% and replaces 150-450W metal halide fixtures. The Prevail fixture and pole combo is ideal for general area/site lighting applications.

SPECIFICATION FEATURES

Construction

Construction is comprised of a heavy-duty, single-piece die-cast aluminum housing in dark bronze polyester powder paint. The die-cast aluminum door is tethered to provide easy access to the driver if replacement is required. The optics is mounted on a versatile, aluminum plate that dissipates heat from the LEDs resulting in longer life of the fixture. The fixture is IP66 and 3G vibration rated (ANSI C136.31).

Optics

Available in Type III and IV distributions with lumen packages ranging from 7,000 to 20,000 nominal lumens. Light engine configurations consist of 1 or 2 high-efficacy LEDs mounted to metal-core circuit boards to maximize heat dissipation and promote long life (up to L91/50,000 hours at 25°C) per IESNA TM-21. For the ultimate level of spill light control, an optional house side shield accessory can be field or factory installed.

Electrical

Available in 120-277V 50/60Hz. 10kV/10kA surge protection standard. 0-10V dimming driver is standard with leads external to the fixture to accommodate controls capability such as dimming and occupancy. Suitable for ambient temperatures from -40°C to 40°C.

Mounting

The versatile, patent pending, standard mount arm accommodates multiple drill patterns ranging from 1-1/2" to 4-7/8". Removal of the door on the standard mounting arm enables wiring of the fixture without having to access the driver compartment. A knock-out on the standard mounting arm enables round pole mounting.

Pole

Shaft is one-piece construction ASTM A500 grade "B" steel, shot blasted and finished in dark bronze polyester powder coat. Anchor base is fabricated from ASTM grade steel. ASTM A366 steel full base cover is provided to enclose base plate and anchor bolts. Anchor bolts are per ASTM A576 with two nuts, two flat washers, and one lock washer. Hardware and threaded portion of bolt are hot dip galvanized. 3" hook for 3/4" bolt. 4" hook for 1" bolt.

Finish

Housing and cast parts finished in five-stage super TGIC polyester bronze powder coat paint, 2.5 mil nominal thickness for superior protection against fade and wear.

Warranty

Five-year warranty.



PPFRV PREVAIL POLE AND FIXTURE COMBO

LED

POLE AND FIXTURE COMBO

DIMENSIONS

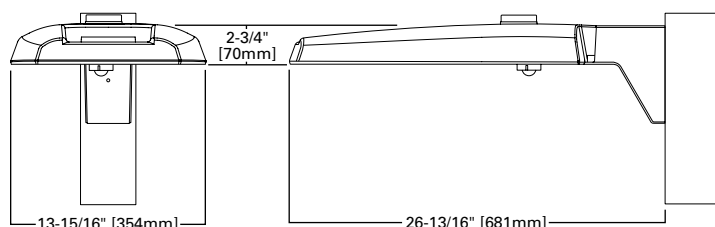

POLE MOUNT ARM

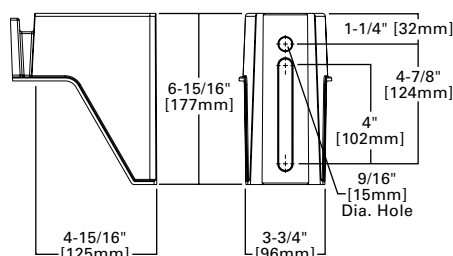

CERTIFICATION DATA

UL and cUL Wet Location Listed
IP66-Rated
3G Vibration Rated
ISO 9001

ENERGY DATA

Electronic LED Driver
0.9 Power Factor
<20% Total Harmonic Distortion
120-277V/50 and 60Hz,
347V/60Hz, 480V/60Hz
-40°C Minimum Temperature Rating
+40°C Ambient Temperature Rating

EPA

Effective Projected Area (Sq. Ft.): 0.75
(1 fixture)

SHIPPING DATA

Approximate Net Weight:
20lbs. [9.09 kgs.] (1 fixture)

CONTROL OPTIONS

0-10V (D)

This fixture is offered standard with 0-10V dimming wire leads for use with a lighting control panel or other control method.

Photocontrol (PER and PER7)

Photocontrol receptacles provide a flexible solution to enable "dusk-to-dawn" lighting by sensing light levels. Advanced control systems compatible with NEMA 7-pin standards can be utilized with the PER7 receptacle.

Dimming Occupancy Sensor (MSP/DIM-LXX)

These sensors are factory installed in the luminaire housing. When a sensor for dimming operation (/DIM) is selected, the luminaire will dim down to approximately 50 percent power after five minutes of no activity detected. When activity is detected, the luminaire returns to full light output.

These occupancy sensors include an integral photocell that can be activated or inactivated with the programming remote / configuration tool for "dusk-to-dawn" control or "daylight harvesting". Note: For MSP sensors, the factory preset is ON (Enabled). The programming remote / tool is a wireless tool that can be utilized to change the dimming level, time delay, sensitivity and other parameters. A variety of sensor lenses are available to optimized the coverage pattern for mounting heights from 8'-30'.

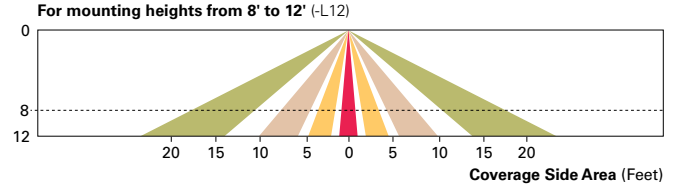
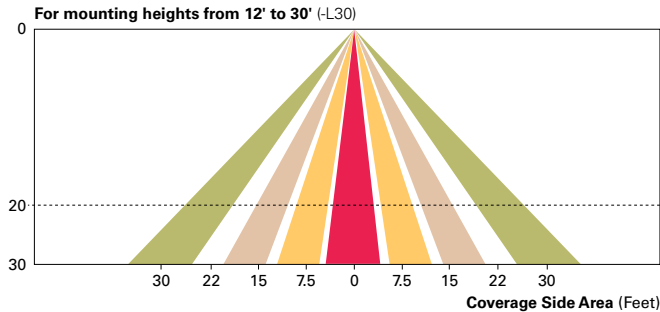

POWER AND LUMENS

| Light Engine | | C15 | C25 | C40 | C60 |
|--------------------------|------------|----------|----------|----------|----------|
| Nominal Power (Watts) | | 57W | 87W | 143W | 163W |
| Input Current @ 120V (A) | | 0.43 | 0.80 | 1.09 | 1.32 |
| Input Current @ 277V (A) | | 0.19 | 0.35 | 0.48 | 0.57 |
| Type III | Lumens | 7,111 | 13,183 | 17,144 | 20,050 |
| | BUG Rating | B1-U0-G2 | B2-U0-G3 | B3-U0-G4 | B3-U0-G4 |
| Type IV | Lumens | 7,088 | 13,140 | 17,087 | 19,984 |
| | BUG Rating | B1-U0-G3 | B2-U0-G4 | B2-U0-G4 | B3-U0-G5 |

LUMEN MAINTENANCE

| Ambient Temperature | TM-21 Lumen Maintenance (50,000 Hours) | Theoretical L70 (Hours) |
|---------------------|--|-------------------------|
| 25°C | > 91.30% | > 194,000 |
| 40°C | > 87.59% | > 134,000 |

LUMEN MULTIPLIER

| Ambient Temperature | Lumen Multiplier |
|---------------------|------------------|
| 10°C | 1.02 |
| 15°C | 1.01 |
| 25°C | 1.00 |
| 40°C | 0.99 |

ORDERING INFORMATION

Sample Number: PFPRV-1-C25-T3-15-N/AB

| Series ^{1,2} | Number of Fixtures | Light Engine | Distribution | Pole Height | Maximum Wind Zone (MPH) | Options (Add as Suffix) | Accessories (Order Separately) |
|--------------------------------------|--------------------------|---|---------------------------|--------------------------------------|---------------------------|---|--|
| PFPRV=Prevail Pole and Fixture Combo | 1=1 2=2 3=3 4=4 | C15=(1 LED) 7,100 Nominal Lumens C25=(2 LED) 13,100 Nominal Lumens C40=(2 LED) 17,100 Nominal Lumens C60=(2 LED) 20,000 Nominal Lumens | T3=Type III T4=Type IV | 15=15' 20=20' 25=25' 30=30' | Blank=80 9=90 0=100 | N/AB=No Anchor Bolts (Used when ordered separately) HSS=House Side Shield ³ MSP/DIM-L12=Integrated Sensor for Dimming Operation, 8' - 12' Mounting Height MSP/DIM-L30=Integrated Sensor for Dimming Operation, 12' - 30' Mounting Height PER=NEMA 3PIN Twistlock Photocontrol Receptacle ⁴ PER7=NEMA 7PIN Twistlock Photocontrol Receptacle ⁴ | HS/VERD=House Side Shield ³ |

NOTES: 1 4000K CCT, standard bronze, 120-277V, 0-10V dimming. 2 Standard mount arm included with fixture. Supplied with straight steel shaft, anchor bolts, template, base cover and hardware. 3 HSS not available with C60 lumen package. Ordered as an option, it will come factory-installed. Ordered as a field-installable accessory, must order quantity one per optic/LED. 4 Not available with MSP options.

PREVAIL POLE AND FIXTURE COMBO

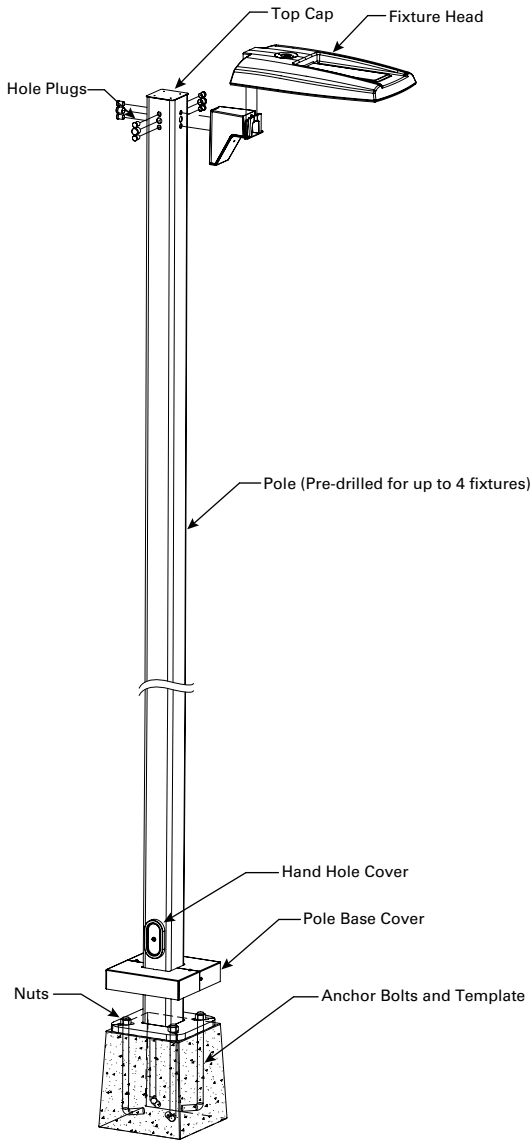

INCLUDED POLE REFERENCE TABLES

| 1 Fixture (EPA= 0.75) | | Wind Zone (MPH) | | |
|-----------------------|--------------------|--------------------------|--------------------------|-----|
| | Pole Height (Feet) | 80 | 90 | 100 |
| | 15 | SSS4A15SFM4 ¹ | | |
| | 20 | SSS4A20SFM4 ¹ | | |
| | 25 | SSS4A25SFM4 ¹ | SSS5A25SFM4 ² | |
| | 30 | SSS5A30SFM4 ² | SSS5M30SFM4 ² | |

| 2 Fixtures (EPA= 1.50) | | Wind Zone (MPH) | | |
|------------------------|--------------------|--------------------------|--------------------------|-----|
| | Pole Height (Feet) | 80 | 90 | 100 |
| | 15 | SSS4A15SFM4 ¹ | | |
| | 20 | SSS4A20SFM4 ¹ | | |
| | 25 | SSS4A25SFM4 ¹ | SSS5A25SFM4 ² | |
| | 30 | SSS5A30SFM4 ² | SSS5M30SFM4 ² | |

| 3 Fixtures (EPA= 2.25) | | Wind Zone (MPH) | | |
|------------------------|--------------------|--------------------------|--------------------------|-----|
| | Pole Height (Feet) | 80 | 90 | 100 |
| | 15 | SSS4A15SFM4 ¹ | | |
| | 20 | SSS4A20SFM4 ¹ | | |
| | 25 | SSS4A25SFM4 ¹ | SSS5A25SFM4 ² | |
| | 30 | SSS5A30SFM4 ² | SSS5M30SFM4 ² | |

| 4 Fixtures (EPA= 3.00) | | Wind Zone (MPH) | | |
|------------------------|--------------------|--------------------------|--------------------------|-----|
| | Pole Height (Feet) | 80 | 90 | 100 |
| | 15 | SSS4A15SFM4 ¹ | | |
| | 20 | SSS4A20SFM4 ¹ | | |
| | 25 | SSS4A25SFM4 ¹ | SSS5A25SFM4 ² | |
| | 30 | SSS5A30SFM4 ² | SSS5M30SFM4 ² | |

NOTES:
1. Uses hardware kit POLSSHDWC4FCHHP.
2. Uses hardware kit POLSSHDWC5FCHHP.