

**Metalux**

# LED Striplights

Our expanded assortment of Linear strip solutions offering both value and performance for your next lighting project

**SNX | SLSTP | ST**





## Metalux LED Striplights

Metalux industrial strip products offer a broad variety of designs, delivering features and performance at an industry best value. With aesthetics that range from the ST traditional tube design to our highly configurable SNX series, Metalux has the solution for your next lighting project.

Click on products to learn more



Lumen and CCT Select Performance LED Strip



Lumen and CCT Select Slim Profile LED Strip



CCT Select Economy LED Strip

### Table of contents

**SNX** 3-6

**SLSTP** 7-10

**ST** 11-14

FEATURES / PERFORMANCE		SNX	SLSTP	ST2 DIM
	Length	2', 4', 8'	2', 4', 8'	2', 4', 8'
	lm/W (Max)	176	148	122
	Lum (Max)	22,000	11,900	9,200
	Life (@60K)	L87	L70/50K	L70/50K
	Dimming	0-10V, Step, Dali	Triac or 0-10V	0-10V
	Lens	Open, Round, FDL, Square	Diffuse, Poly	White, Dual Lens
	Emergency	Integrated	Integrated	Integrated
	CRI	>80 / 90	80+	80+
	Sensor Location	Integrated	Sensor Kit	Remote
	DLC	Premium	Standard	Standard
	Lumen / CCT Select	Yes, specific lumen only	CCT/Lumen	CCT

## Connected lighting system

WaveLinx offers no-hassle lighting control with multiple luminaire level control solutions.

### WaveLinx LITE



WaveLinx LITE is a cost effective, wireless digital lighting control system, with out-of-the-box functionality, that saves energy and meets code. Customize installations using the secure, simple WaveLinx mobile app.

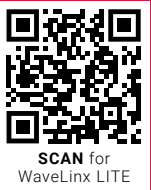

### WaveLinx PRO



WaveLinx PRO is a wireless lighting control solution, for connected spaces, that significantly reduces a building's energy consumption. From a single floor to an entire campus, WaveLinx PRO connects more than lighting assets; it shares aggregated sensor data with the WaveLinx CORE platform and other building systems, so building owners can improve operations, spaces environment, and tenants' experience using a desktop or mobile app.

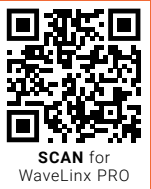

### Integrated sensor controls

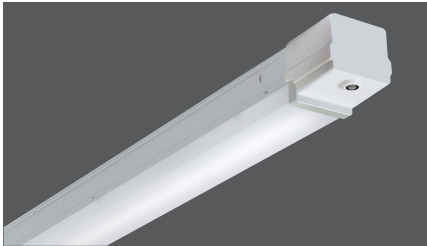

SNX with sensor

### Sensing | Daylight | Wireless

Contains a wireless radio, 0-10V communication interface, motion detector (PIR), daylight sensor (photocell), and an AUX input to be powered by driver auxiliary power outlet. It delivers luminaire-level lighting control (LLLC).

# SNX

Lumen and CCT Select  
Performance LED Strip

The SNX is a versatile, high-performance linear commercial LED striplight with breakthrough fixture efficacy, multiple distributions and numerous configurations.

GENERAL AREA LIGHTING

STORAGE / UTILITY

COVES

SHOPS

TASK

HIGH BAY / LOW BAY



# SNX

- Standard (SL) and High lumen/High Efficacy (HL) packages
- Three (3) CCT and Lumen selectable options available
- Up to 22,000 lumen and 176 LPW
- Enclosed lens, electrical, and channel cover assembly
- General, Narrow or Wide distributions
- Decorative end cover and multiple finishes provide a polished look
- Factory installed controls mean more energy savings
- Captive light channel electrical assembly
- Tool-less channel cover for easy installation and maintenance
- Options to meet Buy American and other domestic preference requirements

## Options and accessories

Lens Options



LC  
Clear Lens



LN  
Semi-Frost Lens - Narrow



LW  
Full Frost Lens - Wide



SLW  
Square/Frost Lens - Wide



FDL  
Flat Frost/Diffuse Lens

Integral Sensor



Factory Installed

Base

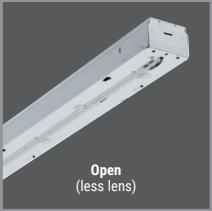

Open  
(less lens)

Accessories



Wire Guard



Decorative End Cap

 Save Money

 Save Time

 Peace of Mind

## Features and benefits

Features		Benefits	Result
Construction	2', 4' and 8' lengths with single continuous lens	Design flexibility for new construction or retrofit applications	\$ ⌚ ✓
	Captive light channel electrical assembly	Toolless access and quicker installation	\$ ⌚
	Flat, round and square lens options	Design and application flexibility	⌚ ✓
Performance	Selectable lumens and 3500, 4000 or 5000K selectable CCT options	Multi-application flexibility	\$ ⌚
	General, narrow and wide distributions options	More choices to address mounting heights and application needs for all markets	✓
	DLC®, 5-year warranty, 60K life hours at L87	Eligible for energy rebates; certified and guaranteed performance	\$ ✓

CERTIFIED

DLC LISTED

DLC LISTED PREMIUM

RoHS COMPLIANT

DIMMABLE

Efficiency Standards  
T24  
Can be used to comply with California Title 24 Non-Residential

selectable colors

selectable lumens

damp location

BAA

Energy and performance data

Catalog number	Length	CCT (K)	Delivered lumens	Watts	Efficacy (lm/W)
2SNX-SL3-LW-UNV-CC83-CD1-U	2	3500	907	6.9	131
		4000	914	6.6	138
		5000	971	6.7	145
		3500	1813	13.9	130
		4000	1942	13.3	146
		5000	1829	13.2	139
		3500	2586	21	123
		4000	2771	20	139
4SNX-SL3-LW-UNV-CC83-CD1-U	4	5000	2943	20.2	146
		3500	2028	16.7	121
		4000	2125	16.1	132
		5000	1947	16.9	115
		3500	4000	33.5	119
		4000	4058	32.3	126
		5000	4241	33.7	126
		3500	6147	50.7	121
8SNX-SL3-LW-UNV-CC83-CD1-U	8	4000	6062	48.9	124
		5000	5900	51.1	115
		3500	4250	33.5	127
		4000	4146	32.3	128
		5000	4137	33.7	123
		3500	7803	66.9	117
		4000	7369	64.5	118
		5000	8273	67.5	123
		3500	12878	101.4	127
		4000	11826	97.8	121
		5000	11548	102.2	113

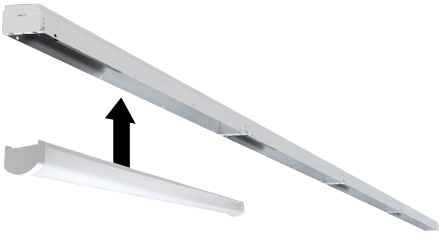

Captive light channel assembly

- Hands free access to driver and electrical
- Tool-less removal for easy install
- Captive lens secured in place
- Independent class 2 LED sub-assembly



Click for animation



## Lumen and CCT Select Slim Profile LED Strip

The SLSTP is a commercial grade LED strip that balances performance, aesthetics, and cost.

## WAREHOUSE

## RETAIL

OFFICE

## RETROFIT



# SLSTP

## End view, Endcap no Sensor

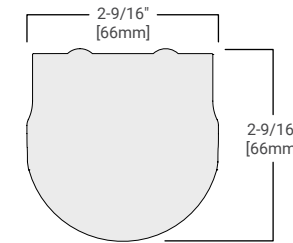

### End view, Endcap with Sensor

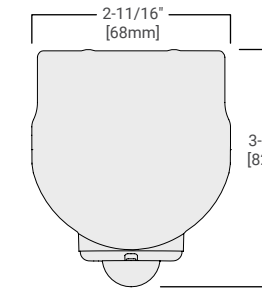

**Standard view, no Endcap**

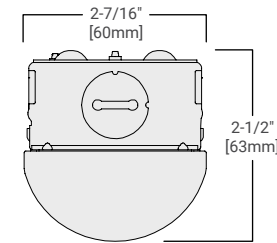

**J-box Cover and Endcap included**



Cover for junction box is shipped standard with fixture, along with hardware to secure cover to J-box.



## Save Money



## Save Time



## Peace of Mind

## Features and benefits

Features		Benefits	Result
Construction	2', 4' and 8' lengths with single continuous lens (all lengths)	Design flexibility for new construction or retrofit applications	💰 ⌚ ✔️
	Decorative snap-on injection molded end caps	Provides clean lines and aesthetically pleasing appearance	✔️
	Impact resistant polycarbonate lens	Reduced maintenance	✔️
	Easy access selectable switches on the outside of the fixture	Contractor friendly; simple in field adjustment	⌚ ✔️
Performance	Up to 150 lm/W, selectable lumens up to 1500 lumens per foot, and 3500, 4000 or 5000K selectable CCT options	Multi-application flexibility	💰 ⌚
	Frosted lens with linear prisms	Uniform light distribution and wide area coverage	✔️
	UNV or NUV (120-347V) input, to 10%, then off	Save over 40% energy over existing LFL strips	💰
	DLC®, 5-year warranty, 50K life hours at L70	Eligible for energy rebates; certified and guaranteed performance	💰 ✔️



Energy and performance data

Catalog number	Length	CCT (K)	Delivered lumens	Watts	Efficacy (lm/W)
2SLSTPSC-UNV	2	3500	2445	22	113
		4000	2585	21	123
		5000	2470	21	115
4SLSTPSLC-UNV	4	3500	2416	18	133
		4000	2418	18	137
		5000	2383	18	134
		3500	3534	31	115
		4000	3627	30	122
		5000	3523	30	116
		3500	5802	48	121
8SLSTPSLC-UNV	8	4000	6045	46	130
		5000	5784	48	121
		3500	4215	34	125
		4000	4321	33	130
		5000	4288	34	127
		3500	7782	64	121
		4000	8141	63	130
		5000	7901	64	123
		3500	10456	88	118
		4000	11119	85	130
		5000	10456	89	118

Options and accessories

Sensor

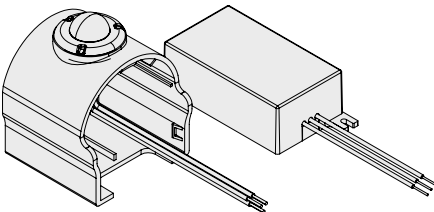

Catalog	Unit UPC	Unit Carton Qty	Case Qty
SLSTP MS00 Kit	080083254200	1	50
SLSTP MS25 Kit	080083254224	1	50

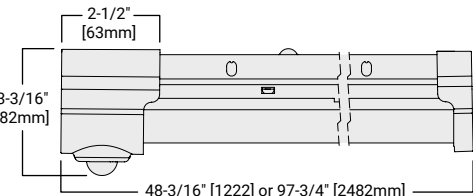

ST

Lumen and CCT Select Economy LED Strip

The ST LED strip features 0-10V dimming and CCT selectable options in stock.

WAREHOUSE

RETAIL

OFFICE



ST

Dimensional and mounting details

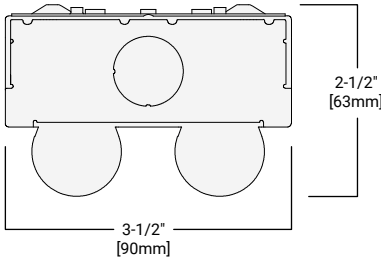



selectable lumens

selectable colors



CCT Selectable (3500, 4000, 5000K) option for greater project flexibility

Ideal for replacing single or two lamp fluorescent strips

Superior performance with lumens up to 9400 lumen and 123 lm/W

Dual lens design for classic fluorescent appearance

Universal 120-277V input, 0-10V dimming to 10%

Mount by itself or in continuous row using included aligner

DLC® compliant, 5-year warranty

Non-dimming single and dual lens ST also available <sup>(1)</sup>

(1) See Cooper Lighting Solutions website for more information.

Features and benefits

\$

Save Money

🕒

Save Time

✅

Peace of Mind

Features		Benefits	Result
Construction	Full length and standard width channel design	No painting required. Ideal for any retrofit LFL project	✅
	Tool-less channel cover, integrated LEDs and wireless access from below	Simple install and maintenance for life of product	🕒
	Surface, chain or toggle mount	Ideal for new construction or retrofit	🕒
	Continuous row mount aligner included	Add-on length as needed regardless of space or layout	\$
Performance	0-10V Dimming, 4000K, Double lens	Additional savings and control; DLC Utility Rebate qualified	\$
	Up to 118 lm/W	Save over 40% energy over existing LFL strips	\$
	Classic single or double lens tube appearance	One for one replacement of 2 or 4-lamp LFL strips	✅
	DLC®, 5-year warranty, 50K life hours at L70	Certified and guaranteed performance	✅



## Energy and performance data

Catalog number	Length	CCT (K)	Delivered lumens	Watts	Efficacy (lm/W)
2ST2L20SC3	2	3500	2233	19	117
		4000	2320		122
		5000	2258		119
4ST2L40SC3	4	3500	4607	40	115
		4000	4760		119
		5000	4653		116
8ST2L80SC3	8	3500	8679	76	114
		4000	9255		121
		5000	8912		117



### **Lighting Brands**

Ametrix  
AtLite  
Corelite  
Ephesus  
Fail-Safe  
HALO  
HALO Commercial  
Invue  
iO  
Iris  
Lumark  
LumarkAP  
Lumière  
McGraw-Edison  
Metalux  
MWS  
NeoRay  
Portfolio  
PrentaLux - 3D Printed Lighting  
RSA  
Shaper  
Streetworks  
Sure-Lites

### **Controls Brands**

Greengate  
Fifth Light  
Intelligent Lighting Controls

### **Connected Lighting Systems and Smart Spaces Platform**

WaveLinx  
Trellix Infrastructure



#### **Cooper Lighting Solutions**

1121 Highway 74 South  
Peachtree City, GA 30269  
P: 770-486-4800  
[www.cooperlighting.com](http://www.cooperlighting.com)

Canada Sales  
5925 McLaughlin Road  
Mississauga, Ontario L5R 1B8  
P: 905-501-3000  
F: 905-501-3172

© 2025 Cooper Lighting Solutions  
All Rights Reserved  
Printed in USA  
Publication No. PS51942723  
May 12, 2025 4:55 PM

Cooper Lighting Solutions is a  
registered trademark.

All other trademarks are property  
of their respective owners.

Product availability, specifications,  
and compliances are subject to  
change without notice.