

**FPX**

LED Flat Panel with Integrated Sensors and Control Options

**Metalux**





# FPX LED panel

The FPX LED panel series provides the high performance and aesthetic appeal of a flat panel while also being optimized for integrated sensors, emergency battery packs and multiple control options. The low-profile design is ideal for shallow plenum grid ceilings or surface mounting. The integrated grid clips enable installation speed and flexibility. FPX is an excellent lighting solution for commercial office spaces, schools, healthcare and retail merchandising areas.

- Variety of controls and emergency battery pack options in all sizes*
- Low profile perfect for renovation or new construction*
- Contractor friendly, quick and easy install*
- No maintenance required*
- Smooth, uniform, glare-free illumination*
- One install = code compliance and maximum energy savings*
- Perfect for low voltage applications using DLVP*

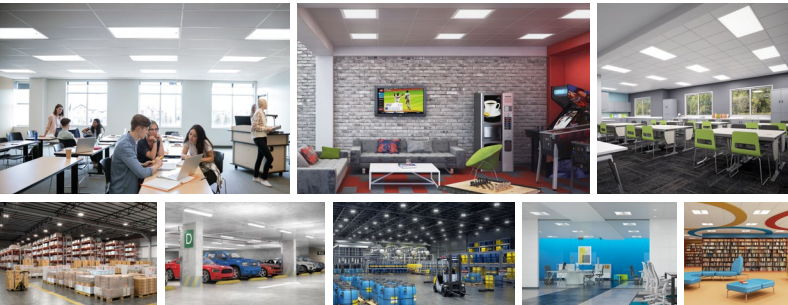
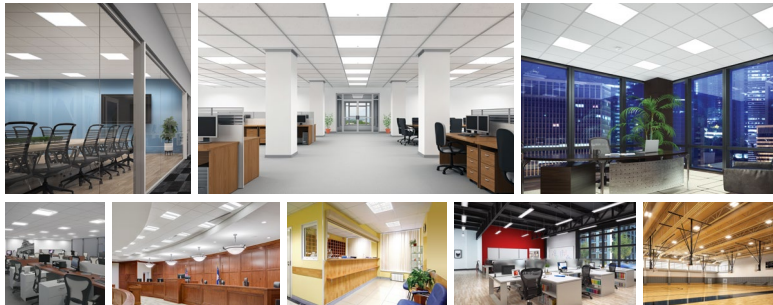



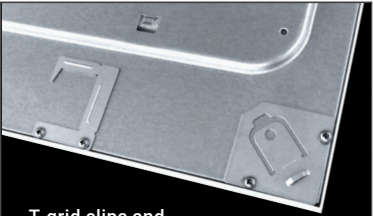

# Durable construction

Integrated components are covered to meet code and ensure long term durability of the product	 <p>T-grid clips and suspension anchors included</p>
Impact and scratch-resistant lens with acrylic light guide	
Rigid steel frame and extruded aluminum bezel	
No maintenance - tight seams and no perimeter openings	

# Fast/simple install

Wire and wire nuts provided – easy to connect fixture to circuit and fixture to fixture	
Multiple trade size KO and J-box rated for 12 AWG wire	
Factory wired EM and sensors deliver code compliance with one simple installation	

# Architectural appeal

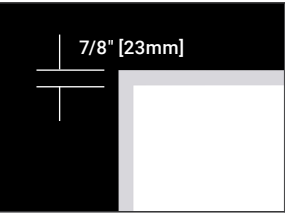
	 <p>7/8" [23mm]</p>
Integrated emergency battery pack and sensor are discretely positioned on the panel	Seamless corners
	Superior Optics with frosted lens provides smooth, even illumination





Performance

High lumen options enable use in high ceilings, lower wattage options maximize energy savings
True replacement of two and three lamp troffers with T8, T5 or BX40 lamps
Long life LED system lasts over 20 years
Five-year warranty

Integrated Controls

0-10V dimming to 10% standard 1% 0-10V, DALI 2.0, Lutron, and step dimming available
WaveLinx sensor compatible for IoT capability
LumaWatt Pro sensor compatible for IoT capability
SVPD sensor compatible for out of the box functionality
DLVP sensor and driver compatible for low voltage applications



Integrated WaveLinx



Emergency Solutions

EL7W=7-watt, 120V-277V emergency battery pack installed
EL14W=14-watt 120V-277V emergency battery pack installed
ELV7W=7-watt, DLVP-compatible low voltage emergency battery pack installed
ELV14W=14-watt DLVP-compatible low voltage emergency battery pack installed
ETRD=Emergency Transfer Relay with dimming control



Integrated Emergency

Compliance and approvals





LM79 / LM80  
Compliant





Lasts  
20  
Years

Accessories

Surface Mount Kit



Easy surface install

Suspension Kit



Simple two-point suspension

Grid Retention



Code and spec compliance

Battery



Fully integrated emergency

5 FPX LED Flat Panel with Integrated Sensors and Control Options

### **Lighting Product Lines**

Ametrix  
AtLite  
Corelite  
Ephesus  
Fail-Safe  
Halo  
Halo Commercial  
Invue  
io  
Iris  
Lumark  
Lumière  
McGraw-Edison  
Metalux  
MWS  
Neo-Ray  
Portfolio  
RSA  
Shaper  
Streetworks  
Sure-Lites

### **Controls Product Lines**

Fifth Light Technology  
Greengate  
iLight (International Only)  
iLumin  
Zero 88

### **Connected Lighting Systems**

Distributed Low-Voltage Power  
HALO Home  
iLumin Plus  
LumaWatt Pro  
WaveLinx  
Trellix



#### **Cooper Lighting Solutions**

1121 Highway 74 South  
Peachtree City, GA 30269  
P: 770-486-4800  
[www.cooperlighting.com](http://www.cooperlighting.com)

Canada Sales  
5925 McLaughlin Road  
Mississauga, Ontario L5R 1B8  
P: 905-501-3000  
F: 905-501-3172

© 2020 Cooper Lighting Solutions  
All Rights Reserved  
Printed in USA  
Publication No. BR519047EN  
February 27, 2020 2:21 PM

Cooper Lighting Solutions is a registered trademark.

All other trademarks are property of their respective owners.

Product availability, specifications, and compliances are subject to change without notice.